



## SOLARIS 44#08 PURE PASSION



YEAR	2012
CURRENT PRICE	€ 385'000 Vat paid
LOCATED IN	Sardina
FLAG	German

This Solaris 44, Javier Soto Acebal design with a white aluminum mast and a carbon V boom, teak deck, electric sail handling with self-tacking jib, is combining perfect performance and cruising in her most elegant way and is still very easy (short-handed) to sail. «PURE» is a stylish, privately owned yacht with a white hull, white mast, V-boom and North 3DL sails. A beautiful appointed and air-conditioned interior in high quality oak, varnished with a matt open pore finish. Very well maintained by the Solaris Service team in Porto Rotondo. Ready to sail away.



## SPECS, EQUIPMENT AND INFORMATION

### GENERAL

YARD	Solaris Yachts / Cantiere Se.Ri.Gi
DESIGNER	Javier Soto Acebal / Solaris Yachts
HULL MATERIAL	Sandwich construction (type PVC Airex Core) in E-fiberglass. The transversal (floor) and longitudinal reinforcements of the hull are made in composite material and well resinbonded to the hull by INFUSION system.
TYPE OF YACHT	Cruiser Racer

### DIMENSIONS

LOA	13.60 m
BEAM	4.18 m
MAX. DRAFT	2.40 m
DISPLACEMENT	9800 kg
BALLAST	4000 kg

### RIG

MAST	Aluminium mast, white painted ROD rigging
BOOM	Hall Spars Carbon Park avenue boom, white painted

### SAILS

<b>NEW 2018 Millenium Arche laminated one piece sails Main sail and jib</b>	1 x fully batten main sail new 2018 Millenium Arche plus North 3DL 2011
	1 x furling Genoa 110% new 2018 from Millenium Arche plus from North 3DL 2011
	1x self-tacking jib 95% from North 3DL 2011
	1x Gennaker from North, color «Fuchsia» 2011
	1x Code0 from North 2011

### ENGINES

ENGINE	VOLVO PENTA D2 75 75 HP
TYPE	Diesel
TRANSMISSION	S-DRIVE
PROPELLER	Maxprop
ENGINE HOURS	approx. < 700
BOW THRUSTER	Compact retract CR70 12V

### GENERATOR

TYPE	Whisper 3,5; 3,5 kW 220V
GENERATOR HOURS	approx. 45



## TANKS

FRESH WATER	420 L
FUEL	260 L
BLACK WATER TANK	2x

## CERTIFICATION

CE RINA	Open Sea Category A
---------	---------------------

## ACCOMODATIONS

FIT OUT	Interior in oak, varnished with matt open pore finish
CABINS	3; 1 Owner cabin, 2 guest cabins
BERTH	Sleeps 6 excl saloon
GALLEY	1x fridge 100 L, 1x fridge 80 L 3 Burner cooker and oven Worktops in Corian 2 stainless steel sinks
TOILETS	2 x electric Tecma Elegance

## HULL AND DECK

Aluminum mast Z Spars with Rod-rigging
Hall spars Carbon Park avenue boom
Full teak deck
Recessed track for the self-tracking Jib
Boom vang. Backstay and outhaul hydraulic (Navtec)
Furling system for Jib and Code0, manual
Gennaker and Code0 deck gear
2 electric Harken winches Rewind RADIAL Eb 46 RWA for halyards
2 electric Harken winches Rewind RADIAL E 46 RWA for genoa sheets
2 electric Harken winches Rewind RADIAL E 46 RWA for the main sail
4 fixed hull windows / 6 opening windows
4x Deck hatched from Solimar flush fitted
Folding cockpit table in teak with storage and padded
2 opening stainless steel gates in guardrail, one on each side
Carbon folding gangway (Manual)
Electro-hydraulic stern platform
Sprayhood 1x
Bimini top 1x
Antifouling new Coppercoat



## ELECTRICAL INSTALLATION

Inverter 12 V/2000 W
Service batteries 540 A
Battery charger 12 V/80 Ah and 12 V/6 A battery generator
12 V sockets in each cabin
Alternator for charging service batteries 1x 115 Ah/12 V
Whisper 3,5; 3,5 kW 220 V generator
LED interior lights
Lopo LED Navigation lights

## ELECTRONICS AND NAVIGATION

Raymarine E 120 Wide
3x Raymarine displays I70
2x Raymarine E7 Touchscreen
Autopilot Raymarine P70, SPX30, T2 plus remote control
Radar/Plotter Raymarine E120 Wide, Random RD218 HD, 18"
4 kW on mast
AIS 600 Transponder RX/TX
GPS Antenna Raystar 125 Plus
Multi-function antenna RR Pacific 3G AIS, router 3G WIFI
Echomax Reflector XS dual band on the mast top
Wireless LAN System
Raymarine instruments – 360 degree wind and enlarged wind (real and apparent wind)
VHF AIS Raymarine 240E with ATIS and 2 stations
Flat TV + DVD/MP3 player
Bose speakers, 1 car stereo with DVD/MP3/CD player and iPod
Cockpit loudspeakers

## ADDITIONAL EQUIPMENT

Bow Thruster, retractable, MAX POWER Compact Retract CR70 12 V
with control from the helm
Electric anchor windlass and Delta Lewmar Inox anchor, 100 m/10 mm
Inox chain with cockpit control
Clima/Heating Webasto split in all cabins and in the salon
Teak outboard bracket
Cockpit cushions and cushions for sundeck
Additional anchor aluminum Fortress
3x white folding mast steps

Harken full-batten mainsail track and gear on mast

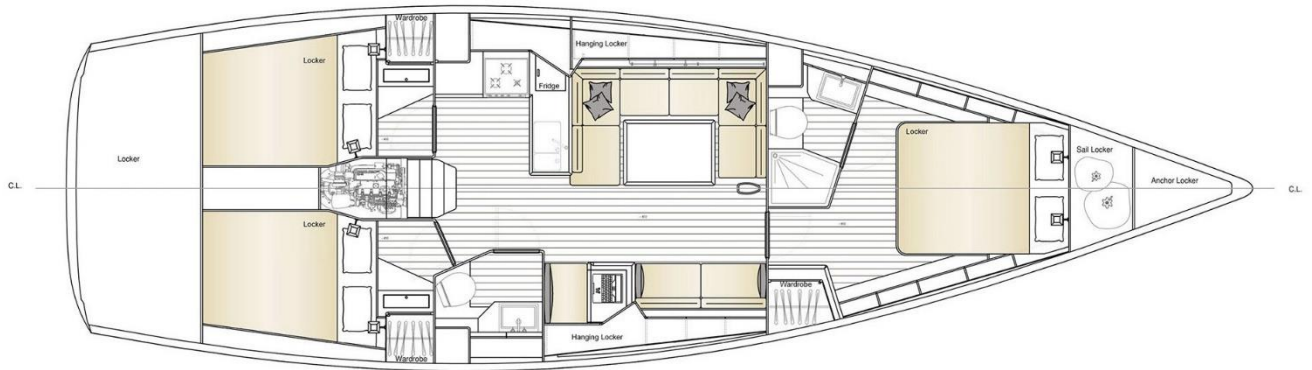





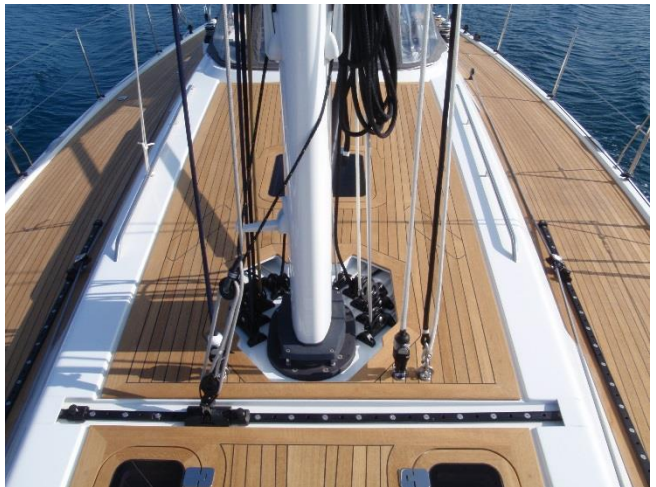









**DISCLAIMER:**

All data considered correct but not guaranteed. This document is not contractual. The Company offers the details of this vessel in good faith but cannot guarantee or warrant the accuracy of this information nor warrant the condition of the vessel. A buyer should instruct his agents, or his surveyors, to investigate such details as the buyer desires validated. This vessel is offered subject to prior sale, price change, or withdrawal without notice.

**UNIBROKERS SOLARIS YACHTS**

**BEN VAES**

[ben.vaes@sycustom.com](mailto:ben.vaes@sycustom.com)

RCNP Plaza Jardines de San Telmo 5

07012 Palma der Mallorca

[www.luxury-marine.com](http://www.luxury-marine.com)

[www.solarisyachts.com](http://www.solarisyachts.com)

[+44 7740 10 25 58](tel:+447740102558)

[+49 172 919 2533](tel:+491729192533)

