



Solaris 60 THE ITALIAN JOB III



Year:	2010
Current Price:	EUR 1,300,000 EUR ex Vat
Located in:	Mallorca, Spain

The ultimate push-button Italian performance cruiser by Solaris, from the board of Bill Tripp. Lifting keel enables access to shallow anchorages whilst ensuring deep draft performance. Every conceivable mod-con to ensure easy sailing by two!

The lifting keel (2.40m minimum draft) enables access to shallow anchorages and marinas, but with the keel down with a 4.10m draft, the increased lift and stability makes this the fastest and most stable Solaris 60 built.

The interior layout is contemporary, light and airy yet exudes the traditional craftsmanship of the Solaris shipyard.



Specs, Equipment and Information

GENERAL

Yard	Solaris Yachts / Cantiere Se.Ri.Gi
Designer	Bill Tripp / Solaris Yachts
Hull Material	GRP/Sandwich Vacuum infusion
Type of Yacht	Cruiser Racer

DIMENSIONS

Loa	18.97 m
Beam	5.11 m
Min. draft	2.39 m
Max. draft	4.09 m
Displacement	25000 kgs

RIG

Hall Spars keel-stepped black painted CARBON mast with 3 sets of aft-swept spreaders.
Clear lacquer to exposed carbon below deck.
Mast water has a dedicated sump box with automatic discharge.
Hydraulic mast jack.
Rod rigging.
LED deck lights at lower spreaders and two sets of LED up-lights.
Navtec central hydraulic system in cockpit, controlling; 2 x backstay rams, and vang.
Reckmann UD3 electro-hydraulic below-deck jib furler, with control button at helm.
Reckmann electro-hydraulic below deck TPE turning pad eye for code zero.
Reckman black anodized aluminium forestay foil with twin grooves.
Electro-hydraulic mainsheet magic trim, with hydraulic ram located beneath cockpit floor. Fast and slow in and out control buttons on both helm consoles and additionally on the side coamings to enable mainsheet trimmer to tune the mainsail when racing.
Halyards lines generally lead aft from base of mast to cockpit electric winches, lead below deck.
Spinlock power clutches port and starboard inside cockpit coamings.
Dyneema code zero and jib sheets.
Dyneema mainsail, jib and 2 x code zero halyards.
Mast top reinforced to take mast head code zero halyards.
Leisurefurl composite black painted electro-hydraulic furling boom.
Harken cockpit-towable genoa cars.



SAILS

North Sails Marathon 3DL in-boom furling mainsail.
North Sails 3DL 800 in-boom furling mainsail.
North Sails Marathon 3DL 106% furling jib.
North Sail 3DL 800 106% jib (2013.)
North Sails 3DL 800 number 3 jib.
North Sails G-2 gennaker (pink) with Future Fibres anti-torsion stay for top-down hydraulic furling.
North Sails furling Code Zero.
North Sails A2 asymmetric spinnaker.

ENGINES

Engine	Yanmar 4LHA-DTP 200hp
Reduction	ZF63V 2.5:1 gearbox
Type	Diesel
Drive	V-drive
Propeller	Shaft driven 4-blade Variprop propeller through P-bracket

GENERATOR

Generator	Mastervolt Whisper 10, 9.4kw, located in the engine compartment
-----------	---

TANKS

Fresh water	800 l
Fuel	600 l
Black and grey water	Available

CERTIFICATION

CE Rina	Ocean Category A
---------	------------------

ACCOMODATION

Fit out	The interior joinery is Burma teak throughout Teak sole boards throughout easily removed with suction gripper White leather upholstery to main saloon and white leather side paneling to owner's forward cabin and main saloon
Forward Master Cabin	Centre-line double berth with storage drawer beneath. Shelving to sides of berth. High level lockers. Large double hanging locker. Overhead deck hatches.



	Vanity table with white leather upholstered stool, mirror and general storage lockers.
Crew Cabin	Forward and to starboard of main saloon (opposite galley). 2 x single bunk beds. The central hydraulic power packs are located beneath the lower bunk, as are the master battery switches for the hydraulics and the domestic batteries. Overhead flush deck hatch with black out blind and mosquito screen.
Crew Cabin En-suite Head	Tecma electric marine WC. Wash hand basin with mixer tap and vanity mirror above. Shower
Berth	8 , excl.saloon,
Galley	Galley forward and to port of main saloon (opposite mast) White Corian counter top Hinged door with rubbish bin High-level storage lockers
Master Cabin En-suite Heads	Shower cubicle Wash hand basin with mixer tap, mirrored vanity unit with storage locker beneath Tecma electric marine WC.
Chart Table	Forward facing chart table to port of main companionway with bosun's locker beneath. White leather navigator's seat.
Port Aft Guest Suite	Double berth with storage beneath. Day diesel tank is located beneath this berth. Access door to main engine room. Large hanging locker. Side shelf. Opening port lights to side deck and cockpit. Overhead deck hatch.
Port Aft Cabin En-suite Heads	Shower. Wash hand basin with mixer tap, mirrored vanity unit with storage locker beneath. Tecma electric marine WC.
Starboard Aft Guest Suite	Double berth with storage beneath. Large hanging locker. Side shelf. Storage locker. Opening port lights to side deck and cockpit. Overhead deck hatch.
Starboard Aft Cabin En-suite Heads	Large Shower. Oilskin wet locker. Wash hand basin with mixer tap, mirrored vanity unit with storage locker beneath. Tecma electric marine WC.
Saloon	Spacious, light and airy with overhead deck hatches, fitted with black out blinds and mosquito screens, 4 x fixed hull windows and opening flush hatch above galley. C-shaped dining area to starboard with large table and seating to three sides. The dining table can be extended. 2 x Round fixed stools to inboard side of table with white leather upholstery. Numerous lockers, drawers, drinks storage and bookshelves. Long settee berth to port side of main saloon.



HULL AND DECK

Hall Spars keel-stepped black painted CARBON mast with 3 sets of aft-swept spreaders.
Clear lacquer to exposed carbon below deck.
Mast water has a dedicated sump box with automatic discharge.
Hydraulic mast jack.
Rod rigging.
LED deck lights at lower spreaders and two sets of LED up-lights.
Navtec central hydraulic system in cockpit, controlling; 2 x backstay rams, and vang.
Reckmann UD3 electro-hydraulic below-deck jib furler, with control button at helm.
Reckmann electro-hydraulic below deck TPE - turning pad eye for code zero.
Reckman black anodized aluminium forestay foil with twin grooves.
Electro-hydraulic mainsheet magic trim, with hydraulic ram located beneath cockpit floor. Fast and slow in and out control buttons on both helm consoles and additionally on the side coamings to enable mainsheet trimmer to tune the mainsail when racing.
Halyards lines generally lead aft from base of mast to cockpit electric winches, lead below deck.
Spinlock power clutches port and starboard inside cockpit coamings.
Dyneema code zero and jib sheets.
Dyneema mainsail, jib and 2 x code zero halyards.
Mast top reinforced to take masthead code zero halyards.
Leisurefurl composite black painted electro-hydraulic furling boom.
Harken cockpit-towable genoa cars.
2 x Harken Radial black anodized B90.2 24v electric 2-speed self-tailing genoa sheet winches.
2 x Harken Radial black anodized 24v 2-speed self-tailing electric halyard winches.
Flush/retractable Sanguinetti 24v electric capstan winch on bow for mooring lines.
Gandola integral telescopic electro-hydraulic access gangway in transom.
Transom garage with 24v Electro-hydraulic opening transom with integral access ladder from deck to bathing platform. Separate swim ladder.
Forward sail locker.
Teak cockpit table with folding leaves on stainless steel frame with additional teak storages units and canvas cover.
2 x Side deck lazarette storage lockers for gas bottles and general storage.
2 x Halyard tail lockers in cockpit floor.
Liferaft stowage pod beneath teak grating in cockpit sole near main companionway.
2 x Pushpit corner seats with removable seat and back-rest cushions.
Stainless steel open-style pulpit.
Carbon flag pole.
Carbon boat hook.
Custom cradle for storage of vessel ashore.
Stainless steel electro-hydraulic retractable below-deck anchor arm.
100m galvanized 12mm calibrated anchor chain.
40kg galvanized Delta anchor.



Various mooring warps.
Various mooring fenders.
6 x Stainless steel folding mooring cleats, bow, stern and mid-ships.

ELECTRICAL INSTALLATION

24v domestic and 12v engine and generator start systems
220v sockets at galley, chart table, owners and guest cabins
24 v domestic bank of 900 ah deep cycle gel batteries located centrally in the saloon
2 x 12 v 100ah engine/generator start batteries
Mastervolt 100ah 24v battery charger for domestic group
Mastervolt 30ah 12v battery charger for main engine and generator start batteries
1 x 150 Ah/24v alternator for service batteries on the main engine
220V is supplied by inverter, shore power or generator
220V ac sockets in each cabin, galley, saloon and chart table
1 x 24/220v. inverter, capacity 1.500 W, Mastervolt
AC/DC distribution panel is divided in two sections
1 x Switchboard for 220v AC, protection and distribution control with automatic thermo magnetic switches and check lights
1 x Switchboard for 24v DC, protection and distribution control with automatic thermo magnetic switches and check lights for all consumers
Digital monitors: voltmeter and amp meter for AC and DC current
DC electric system protected from overload and short circuit by general thermo magnetic switches mounted near the batteries, one for every battery group and each consumer
LED flush mounted interior lighting throughout
LED red night lighting to main companionway steps and chart table
Chrome reading lamps to all cabins

ELECTRONICS AND NAVIGATION

Raymarine E90W colour multifunction screen positioned on port steering console
Raymarine autopilot SPX 30 with hydraulic linear drive and ST70 control head
3 x Raymarine ST70+ maxi displays at mast in Hall Spars carbon housing
2 x Raymarine ST290 analogue wind displays
Ray 240 E cockpit VHF unit
Raymarine 18" 4kw HD digital mast mounted radome - painted black to match mast
Raymarine Raystar 125 GPS antenna
Raymarine Smart Controller
Raymarine C120W colour multifunction screen
AIS receiver
Navtex NX-300
Ray 240E VHF
Raymarine ST70 display



Samsung flat screen TV mounted port side in main saloon behind high level cabinetry, with Glomex masthead TV antenna

CD/DVD/MP3 player with 2 x saloon speakers and 2 x cockpit speakers

ADDITIONAL EQUIPMENT

Hydraulic Bow Thruster retractable Mod. MAX POWER R200/8 24 V with control on the helm station

24000 BTU Veco air-conditioning cooling and heating system

Inflatable dinghy - Zodiac Aero 260 (2013)

Outboard engine - Mercury 3.5(2013) on removable hoist

GRP recess for stowage of sprayhood, with snood cover.

Helm console covers.

Steering wheel covers.

Boom cover.

Sprayhood with stainless steel frame.

Inflatable dinghy - Zodiac Aero 260 (2013).

Outboard engine - Mercury 3.5(2013) on removable hoist.

SAFETY

Ocean Safety Solas B 8 man valise liferaft

10 x Commodore auto lifejackets with harnesses and lights

Icom M33 hand-held VHF

2 x Horse shoe life rings with strobe lights

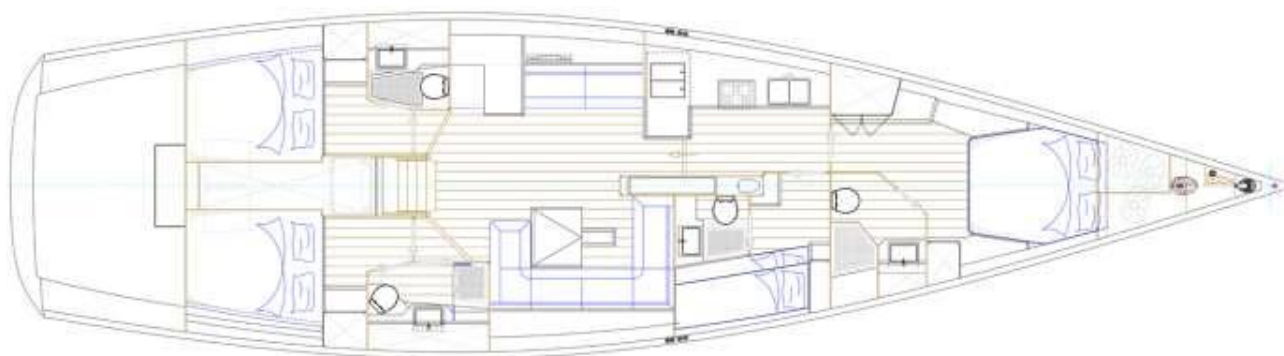





Disclaimer:

All data considered correct but not guaranteed. This document is not contractual. The Company offers the details of this vessel in good faith but cannot guarantee or warrant the accuracy of this information nor warrant the condition of the vessel. A buyer should instruct his agents, or his surveyors, to investigate such details as the buyer desires validated. This vessel is offered subject to prior sale, price change, or withdrawal without notice.



SOLARIS YACHTS CUSTOM

Ipswich Haven Marina, New Cut East

Ipswich IP3 0EA England

www.luxury-marine.com

www.solarisyachts.com

ben.vaes@sycustom.com

+44 7740 10 25 58